

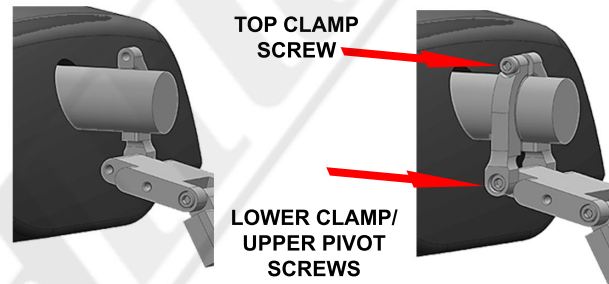

INSTALLATION INSTRUCTIONS FOR BLACKVUE DR750X Plus, DR900X Plus, DR900X , DR750X DR900S, DR750S, DR650S, DR650GW, DR600GW, DR590, DR490, DR470, DR450, DR430

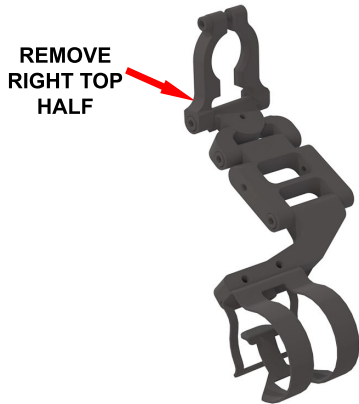

1 - To install the dashcam into the mount, simply squeeze the two tabs of the spring clip together as shown above. This will increase the diameter of the spring clip and allow you to slide the dashcam into position. Once the dashcam is in position, release the two tabs. The dashcam is now securely attached to the mount.



2 - Install the mount while sitting in the passenger side of your vehicle. Remove the right-top half of the mount and position the mount around the mirror stem as shown above. Reattach the right side of the mount. Make sure the lock washer is still on the lower clamp / upper pivot screw. Leave the top clamp screw loose so the mount can slide along the mirror stem and rotate to the desired location. There may be a plastic oval clip around a wire on the stem, the clip must be removed to install the mount. **Lightly snug screws, do not fully tighten until last step.**

CENTER LINK

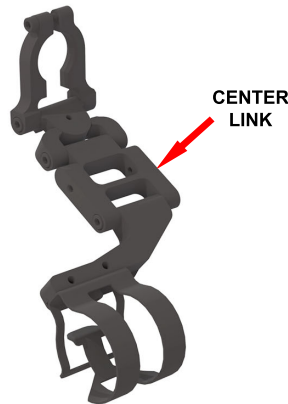

3 - The center-link may be removed if an overall shorter mount length is needed, depending on your rear view mirror and desired position for the dashcam.

With center link installed



BLENDMOUNT ADJUSTMENTS

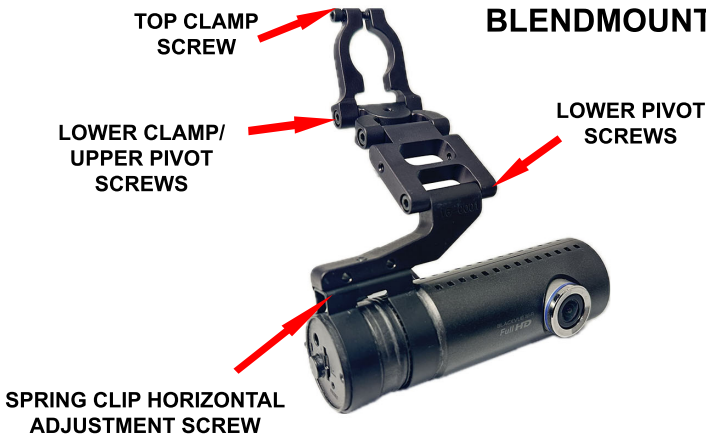

SPRING CLIP HORIZONTAL ADJUSTMENT SCREW

4 - Using the upper and lower pivot screws, adjust the mount to achieve your desired location of the dashcam. We recommend adjusting it as high as you can. You can also use the spring clip horizontal adjustment screw to help center the dashcam with the mirror as shown above.

MIRROR ADJUSTMENTS

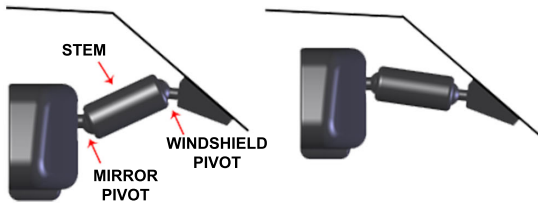

Grab the mirror and move the stem up or down using the windshield pivot only



Mirror stem can pivot left/right to point dashcam where desired

5 - Most compatible mirrors have a stem between the mirror and the windshield that has a pivot on both ends. To adjust the mirror up or down, grab the mirror and move the stem up or down using the windshield pivot only. Adjust the mirror to your normal viewing position using the mirror pivot only. Notice the different location of the mirror shown above.

NOTE: The mirror stem may move side to side as well if needed.

With both the mount adjustments and mirror adjustments you should be able to achieve the perfect placement of your dashcam.



**TOP CLAMP SCREW
TIGHTEN LAST!!!**

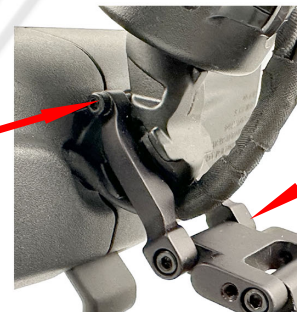

LOWER CLAMP/ UPPER PIVOT SCREWS

6 - At this point your dashcam should be positioned where you want it and the screws should be snug. Loosen the top clamp screw so both the lower clamp/upper pivot screws can be fully tightened. Grab the long arm of the allen wrench to assure that these screws are securely tightened.

You will not strip out the tapped holes in the aircraft grade aluminum. **The lower clamp screws should be fully tightened before tightening the top clamp screw. If the top screw is tightened before the bottom screws are, the clamp may loosen over time.**

FOR MORE INFO VISIT www.blendmount.com/videos

CAUTION

DO NOT use this mount if it interferes with the adjustability or the operation of your rear view mirror in any way.

DO NOT use this mount if the dashcam creates an unsafe viewing obstruction.

DO NOT ATTEMPT TO MODIFY THIS PRODUCT. Consult the manufacturer for assistance.

All BlendMount products are accompanied with detailed installation instructions and adjustment tips. You are encouraged to contact customerservice@blendmount.com or call J28 Design at 1-888-497-8388 for further assistance.

Check the BlendMount Forum for installation tips and some vehicle specific installs.
www.blendmount.com

Your feedback is very important to us. Please email any questions or comments you have to customerservice@blendmount.com